

# FLORIDA DEPARTMENT OF ENVIRONMENTAL PROTECTION

## CERTIFIED CORNER RECORD

DOC. # \_\_\_\_\_

N-5

CORNER DESCRIPTION: \_\_\_\_\_ MONUMENTATION DESCRIPTION (EVIDENCE FOUND OR METHOD TO SET) \_\_\_\_\_

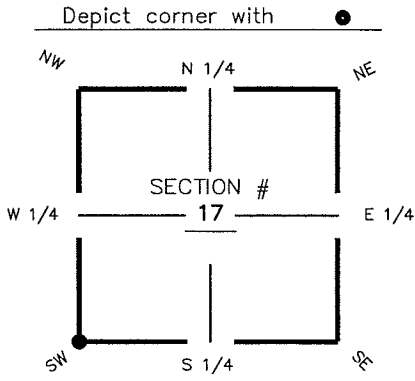

SET P.K. NAIL & DISK  
"AIM ENG. LB 3114"

(RESET CORNER PER RIGHT-OF-WAY  
MAPS OF S.R. 82 - F.D.O.T. PROJECT  
NO. 12070-2524)

SW corner of Section 17  
Twp 44 S, Rge 25 E  
Tallahassee Base Meridian,  
LEE County(s), Florida

HORIZONTAL POSITION INFORMATION ( if determined ):

Latitude 26° 38' 27.9144" N Longitude 81° 50' 24.4529" W  
Y(NORTHING-Ft.) 838740.36 X(EASTING-Ft.) 708389.13 Zone FL W  
Convergence 00° 04' 18.1" Scale factor 0.99994430  
Coordinate determination (circle one): Field traverse GPS  
Horizontal datum (circle one): NAD27 NAD83(1986) NAD83(1990) other (explain) \_\_\_\_\_  
Accuracy (circle one): 1st 2nd 3rd other \_\_\_\_\_

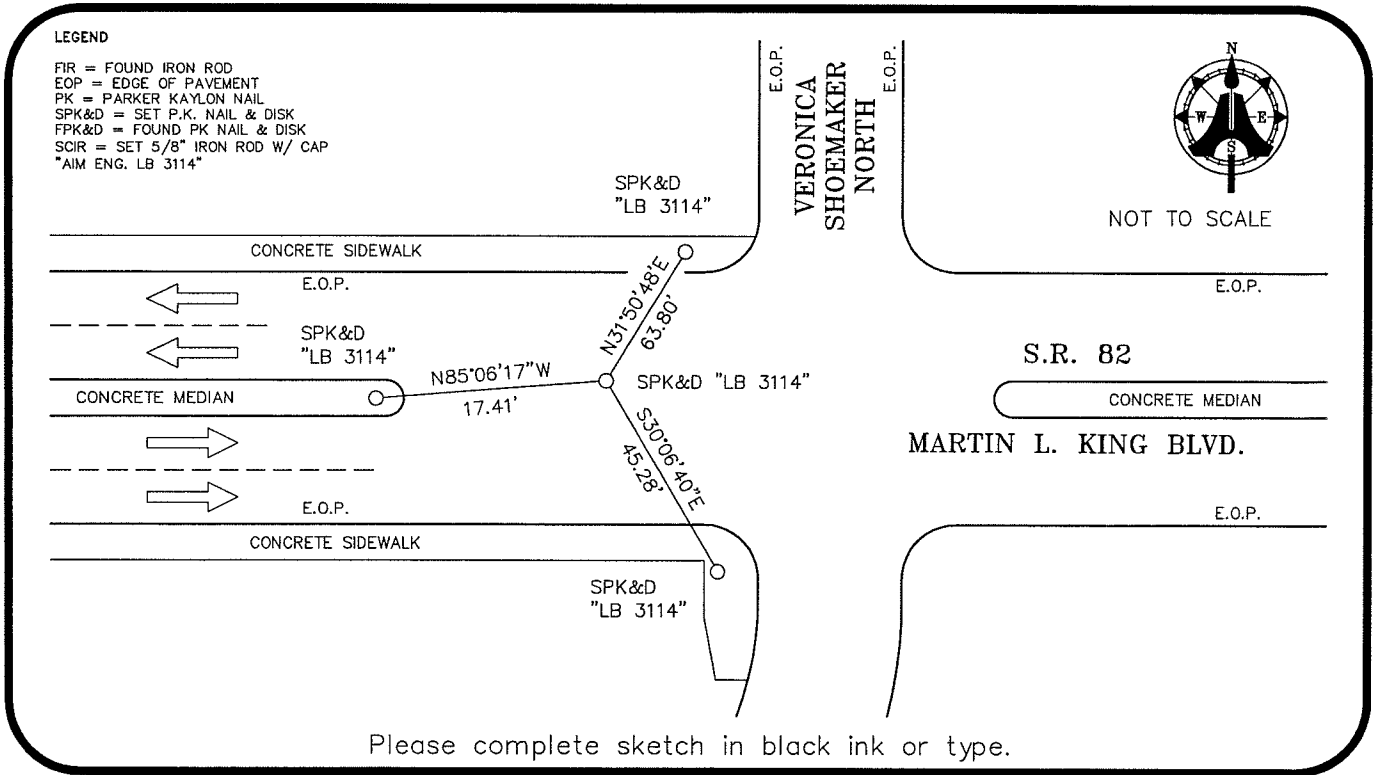

SURVEYORS CERTIFICATE:

I certify the monument and accessories indicated above were field located on AUGUST 21, 2006

SEND ORIGINAL TO:  
Department of Environmental Protection  
Bureau of Surveying and Mapping  
3900 Commonwealth Boulevard  
Mail Station 105  
Tallahassee, Florida 32399

SIGNATURE \_\_\_\_\_ 5688 PSM NO.  
AIM ENGINEERING & SURVEYING, INC. LB 3114 LB NO.  
FIRM OR AGENCY \_\_\_\_\_  
5300 LEE BOULEVARD ADDRESS  
LEHIGH ACRES, FLORIDA 33971-1026  
CITY STATE ZIP  
(239) 332-4569 9/11/06 DATE  
PHONE NUMBER

EMBOSSSED SEAL OVER SIGNATURE

D.E.P. USE ONLY
Processed: _____
B.L.M. - I.D. <u>200 400</u>
QUAD - I.D. _____