

FLORIDA DEPARTMENT OF ENVIRONMENTAL PROTECTION  
 CERTIFIED CORNER RECORD

V-17

DOC. # 084420

CORNER DESCRIPTION: MONUMENTATION DESCRIPTION (EVIDENCE FOUND OR METHOD TO SET)

Depict corner with ●

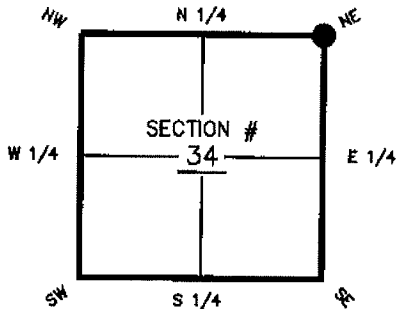

FOUND PK NAIL & DISK LS 2995

HORIZONTAL POSITION INFORMATION ( if determined ):

Latitude 26°-36'-46.83009" Longitude 81°-47'-27.81556"

Y(NORTHING-Ft.) 828557.094 X(EASTING-Ft.) 724433.099 Zone WEST

Convergence 0°-05'-37.0" Scale factor 0.99994652

Coordinate determination (circle one): Field traverse (GPS)

Horizontal datum (circle one): NAD27 NAD83(1986) (NAD83(1990)) other (explain)

Accuracy (circle one): 1st 2nd 3rd other 1:50,000

NE corner of Section 34  
 Twp 44S, Rge 25E  
 Tallahassee Base Meridian,  
LEE County(s), Florida

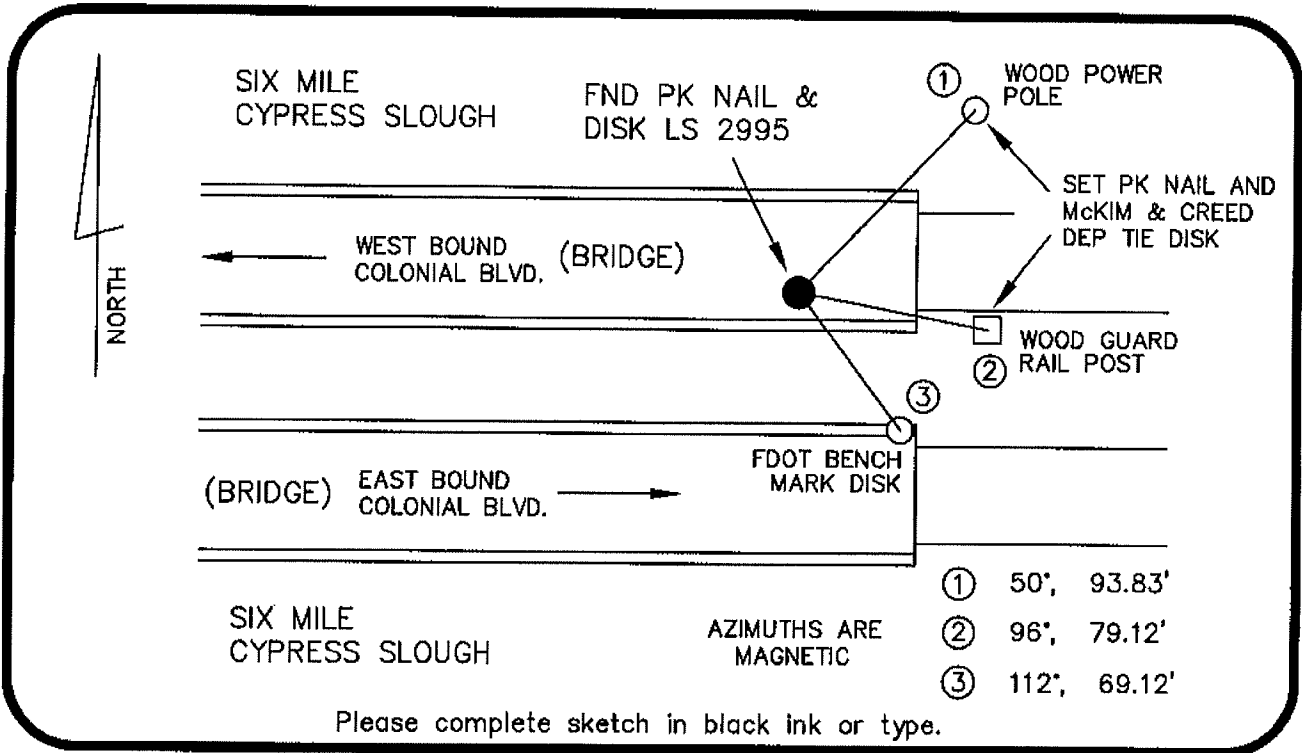

SURVEYORS CERTIFICATE:

I certify the monument and accessories indicated above were field located on 7-06-04

*[Signature]*  
 SIGNATURE  
McKIM & CREED PSM NO. 6008  
6241 ARC WAY LB NO. 6566  
FORT MYERS ADDRESS  
 CITY STATE ZIP  
(239) 275-8875 FL 33912  
 PHONE NUMBER DATE  
05-02-05

SEND ORIGINAL TO:  
 Department of Environmental Protection  
 Bureau of Surveying and Mapping  
 3900 Commonwealth Boulevard  
 Mall Station 105  
 Tallahassee, Florida 32399

D.E.P. USE ONLY  
 Processed: 5-9-05 S.M.  
 B.L.M. - I.D. 500200  
 QUAD - I.D. 2115 Fort Myers SE

EMBOSSSED SEAL OVER SIGNATURE