

**FLORIDA DEPARTMENT OF ENVIRONMENTAL PROTECTION
CERTIFIED CORNER RECORD**

102112

DOC. # _____

CORNER DESCRIPTION:

Depict corner with _____ ●

MONUMENTATION DESCRIPTION (EVIDENCE FOUND OR METHOD TO SET)

SET 5/8" IRON ROD AND CAP "FDOT LBI221"

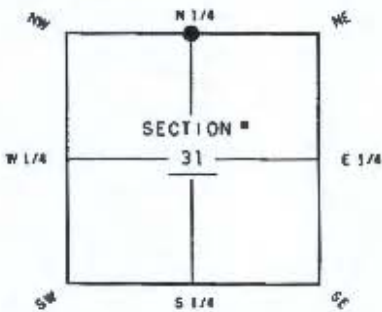

HORIZONTAL POSITION INFORMATION (if determined):

Latitude 26° 36' 47.65700" N Longitude 81° 45' 03.84887" W
 Y(NORTHING-Ft.) 828663.974 X(EASTING-Ft.) 737499.050 Zone FL-WEST
 Convergence 0° 06' 41.4" Scale factor 0.999948761
 Coordinate determination (circle one): Field traverse GPS
 Horizontal datum (circle one): NAD83(1999) other (explain) _____
 Accuracy (circle one): 1st 2nd 3rd other _____

N 1/4 corner of Section 31
 TWP 44 S RGE 26 E
 Tallahassee Base Meridian,
LEE County(s), Florida

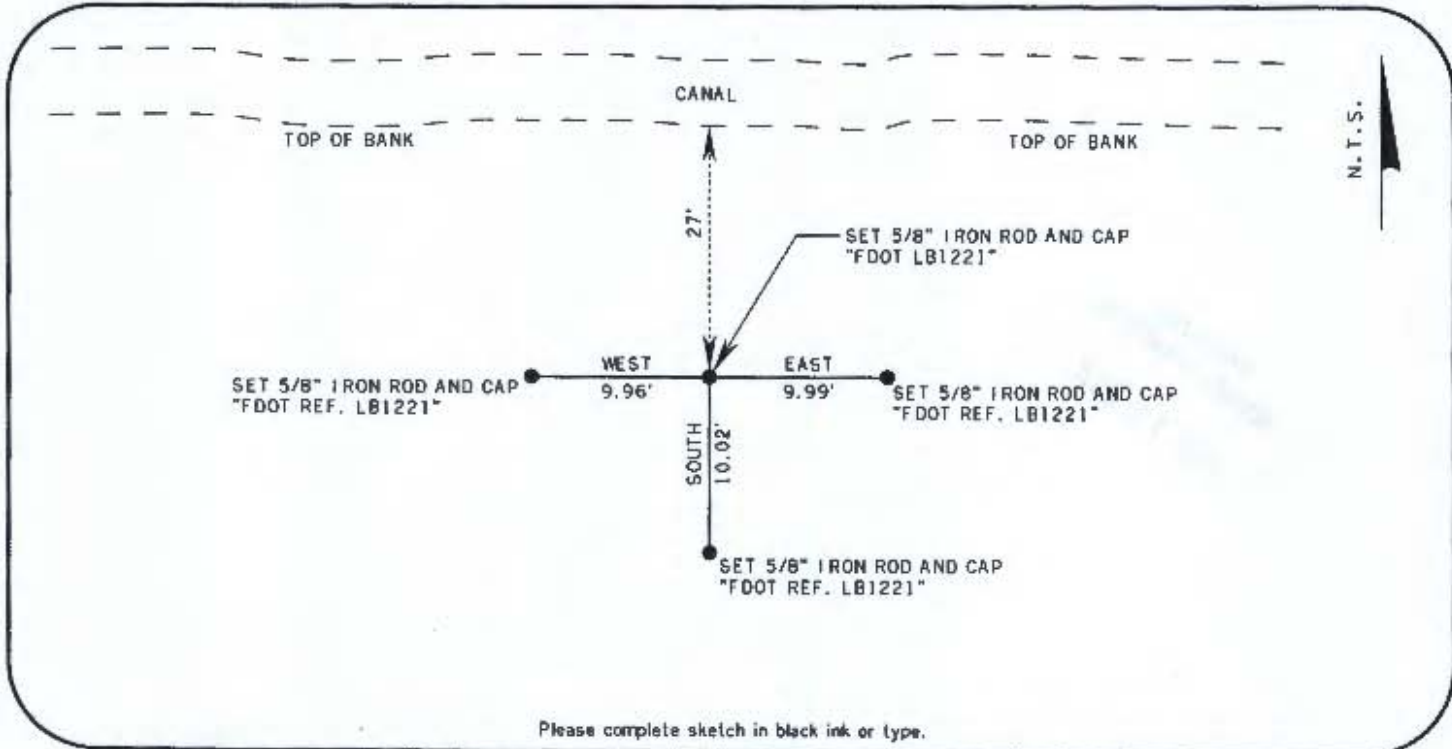

Please complete sketch in black ink or type.

SURVEYORS CERTIFICATE:

I certify the monument and accessories indicated above were field located on

OCTOBER 4, 2011

William P. Humble
 SIGNATURE PSM NO. 4633
 BOWYER-SINGLETON & ASSOC., INC. 1221
 FIRM OR AGENCY LB NO.
 520 SOUTH MAGNOLIA AVE.
 ORLANDO, FLORIDA 32801
 407-843-5100
 DATE NOVEMBER 11, 2011
 PHONE NUMBER

SEND ORIGINAL TO:
 Department of Environmental Protection
 Bureau of Surveying and Mapping
 3900 Commonwealth Boulevard
 Mail Station 105
 Tallahassee, Florida 32399

D.E.P. USE ONLY

Processed: 11-18-11 WLE
 B.L.M. - I.D. 140200
 QUAD - I.D. 2115 FORT MYERS SE

EMBOSSSED SEAL OVER SIGNATURE