

FLORIDA DEPARTMENT OF ENVIRONMENTAL PROTECTION CERTIFIED CORNER RECORD

DOC. # 087921

R-3

CORNER DESCRIPTION: MONUMENTATION DESCRIPTION (EVIDENCE FOUND OR METHOD TO SET)

Depict corner with

FOUND PK NAIL & DISK "INK ENGINEERING PCP REF LB356"

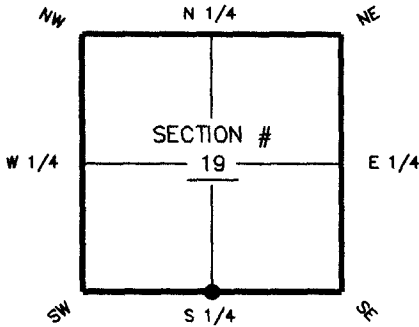

HORIZONTAL POSITION INFORMATION (if determined):

Latitude 26° 32' 21.4003" N Longitude 81° 50' 49.1172" W
 Y(NORTHING-Ft.) 801731.27 X(EASTING-Ft.) 706195.44 Zone FL W
 Convergence ±00° 04' 06.1" Scale factor 0.999944046

S corner of Section 19
 Twp 45 S, Rge 25 E
 Tallahassee Base Meridian,
LEE County(s), Florida

Coordinate determination (circle one): Field traverse GPS
 Horizontal datum (circle one): NAD27 NAD83(1986) NAD83(1990) other (explain)
 Accuracy (circle one): 1st 2nd 3rd other _____

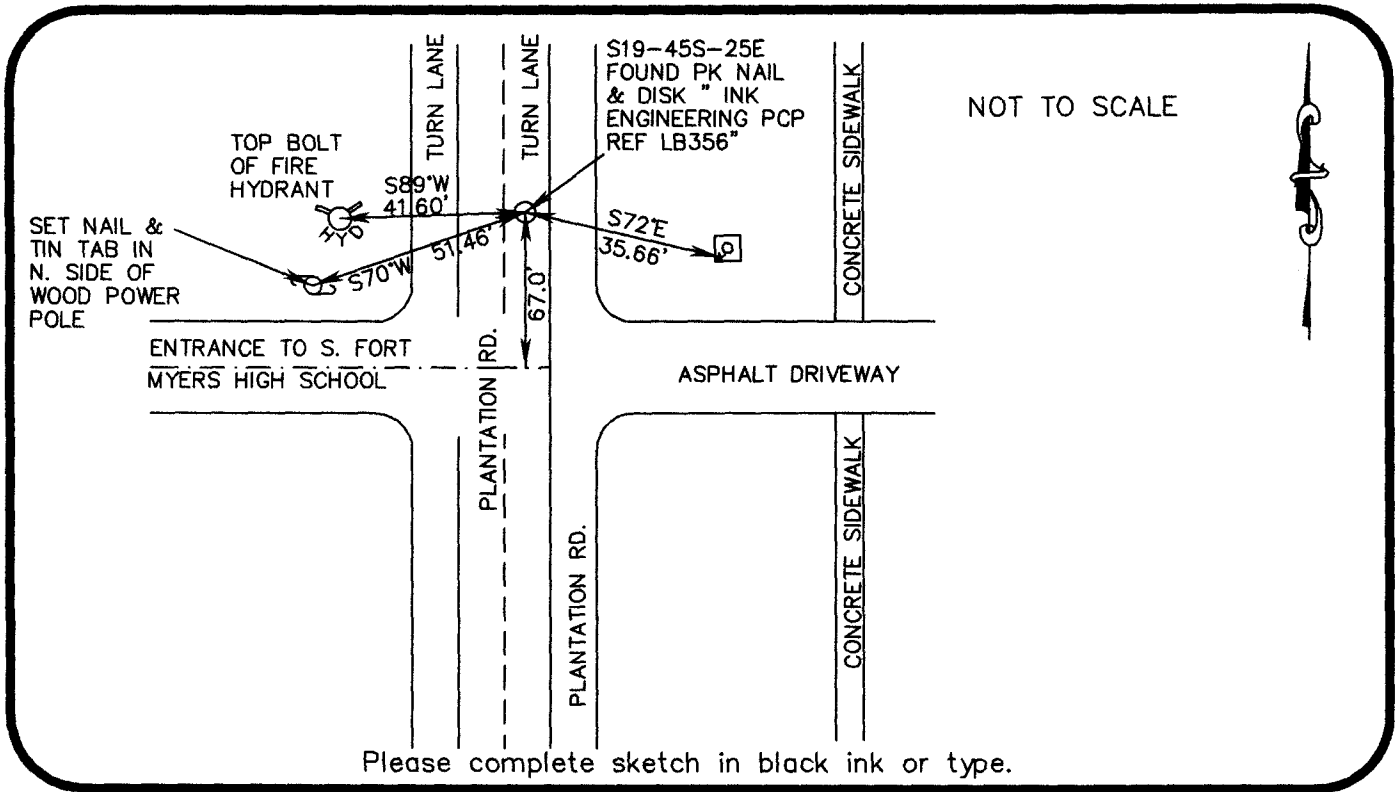

SURVEYORS CERTIFICATE:

I certify the monument and accessories indicated above were field located on SEPTEMBER 19, 2005

SIGNATURE: *Ke. Pappalardo* PSM NO. 6126
 FIRM OR AGENCY: _____ LB NO. _____
 ADDRESS: 2802 W CYPRESS AVE SE
FT. MYERS CITY FLORIDA STATE 33905 ZIP
 PHONE NUMBER: (239) 462-1981 DATE: 3/10/06

SEND ORIGINAL TO:
 Department of Environmental Protection
 Bureau of Surveying and Mapping
 3900 Commonwealth Boulevard
 Mail Station 105
 Tallahassee, Florida 32399

D.E.P. USE ONLY

Processed: _____

B.L.M. - I.D. _____

QUAD - I.D. _____

EMBOSSSED SEAL OVER SIGNATURE