

FLORIDA DEPARTMENT OF ENVIRONMENTAL PROTECTION
CERTIFIED CORNER RECORD

094500

DOC. # _____

CORNER DESCRIPTION: MONUMENTATION DESCRIPTION (EVIDENCE FOUND OR METHOD TO SET)

Depict corner with 

FOUND 6" X 6" CONCRETE MONUMENT WITH IRON ROD - NO I.D.

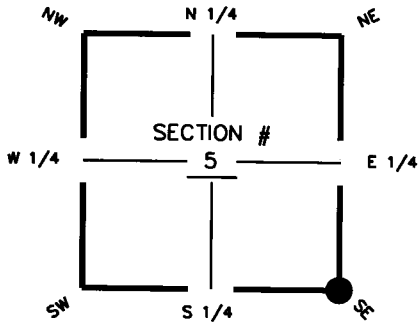

SE corner of Section 5
Twp 45 S, Rge 27 E
Tallahassee Base Meridian,
LEE County(s), Florida

HORIZONTAL POSITION INFORMATION (if determined):

Latitude 26° 35' 05.6488" N. Longitude 81° 37' 45.2232" W.
Y(NORTHING-Ft.) 818460.688 X(EASTING-Ft.) 777337.717 Zone WEST
Convergence 0° 09' 57.3507" Scale factor 0.999958011
Coordinate determination (circle one): Field traverse GPS
Horizontal datum (circle one): NAD27 NAD83(1986) NAD83(1999) other (explain)
Accuracy (circle one): 1st 2nd 3rd other 1:50,000

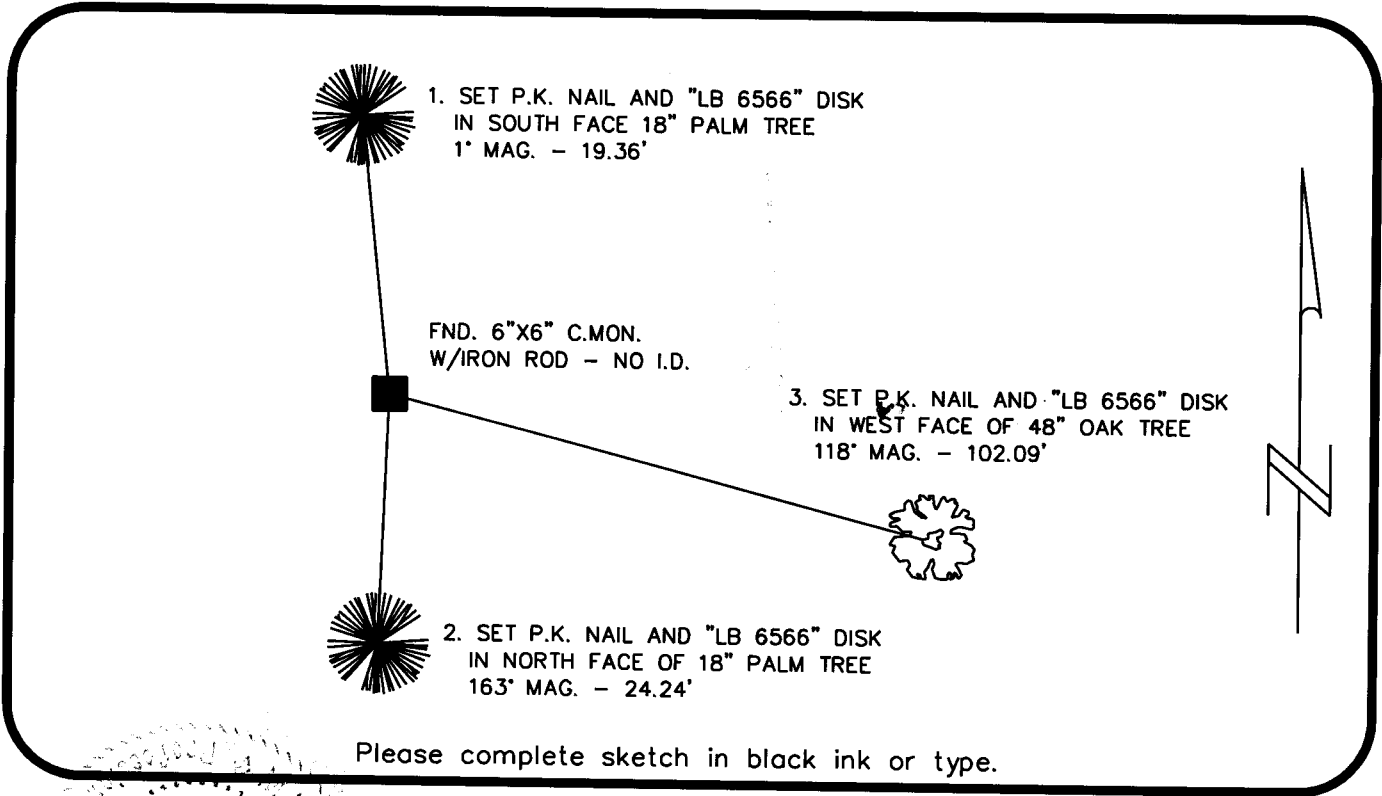

Please complete sketch in black ink or type.

SURVEYORS CERTIFICATE:

I certify the monument and accessories indicated above were field located on 04/29/08

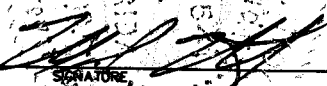

SIGNATURE 6541
McKIM & CREED, P.A. PSM NO.

FIRM OR AGENCY 6566
10970 S. CLEVELAND AVENUE, SUITE 401 LB NO.

ADDRESS
FORT MYERS FLORIDA 33907

CITY STATE ZIP
(239) 275-8875 5-22-2008

PHONE NUMBER DATE

EMBOSSSED SEAL OVER SIGNATURE

SEND ORIGINAL TO:
Department of Environmental Protection
Bureau of Surveying and Mapping
3900 Commonwealth Boulevard
Mail Station 105
Tallahassee, Florida 32399

D.E.P. USE ONLY
Processed: 6-1-08 MB
B.L.M. - I.D. 300600
QUAD - I.D. 2114 Alva SW