

LAND CORNER RECORD

PUBLIC WORKS
LEE COUNTY, FLORIDA

Address - 1500 Monroe St., Ft. Myers, Fla. 33901 Phone : (239) 479-8900

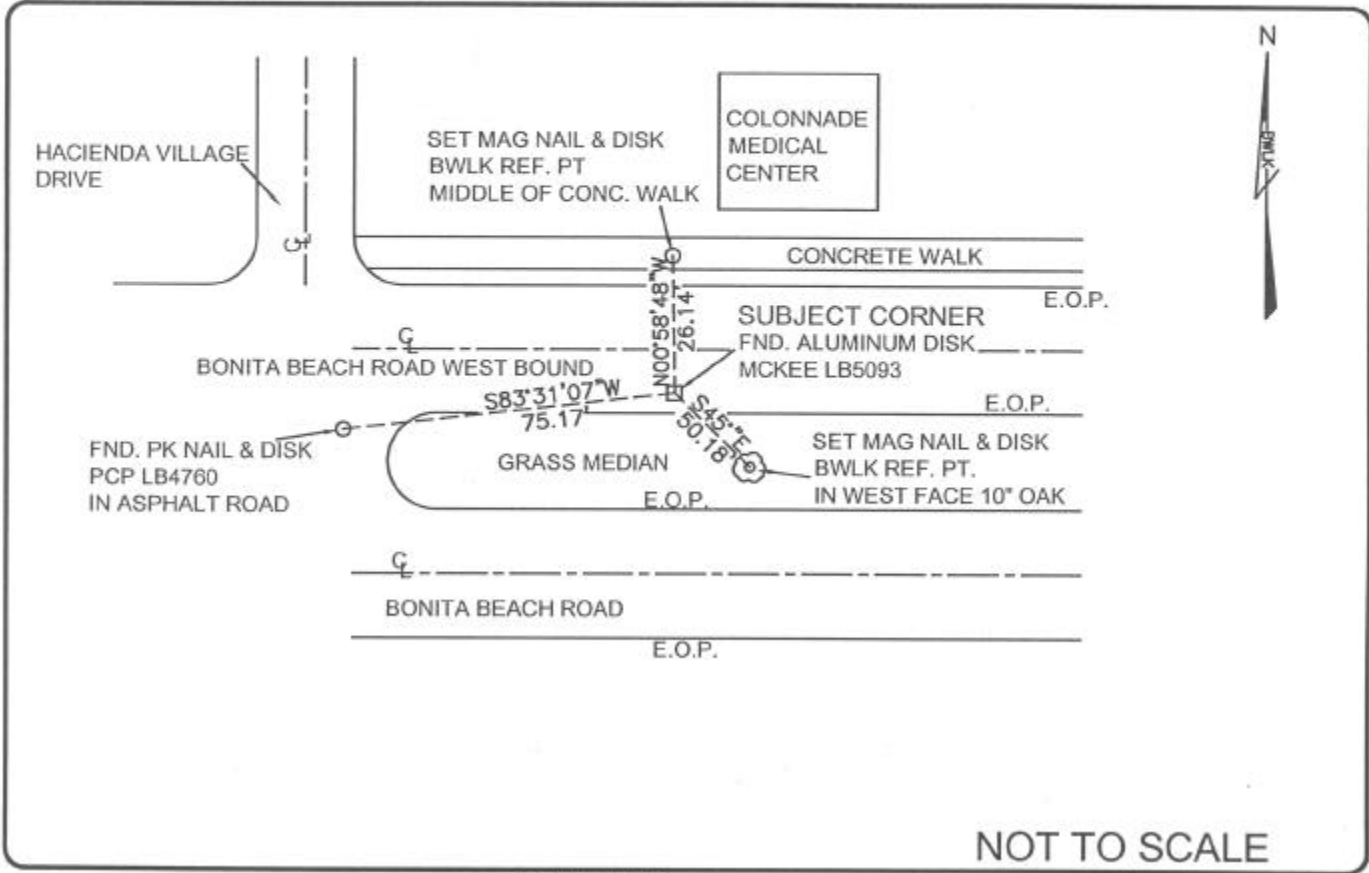

COMMENTS:
Recovered corner and 1 reference as described on CCR #77444.

CORNER DESCRIPTION

S 1/4 Corner
Section 34
Township 47
Range 25



HORIZONTAL POSITION INFORMATION

Florida West Zone, NAD 1983(1990 Adjustment)
Northing(ft) 726003.446 Easting(ft) 723329.851
Latitude 26°19'51.135"N Longitude 81°47'41.774"W
Scale Factor .999946349

EXISTING CERTIFIED CORNER RECORDS

Document No.	Date
<u>77444</u>	<u>01-10-03</u>
<u>25044</u>	<u>04-02-87</u>
<u>36025</u>	<u>07-90</u>

The above documents are based on FDEP Bureau of Surveying and Mapping Record Information.

I hereby certify the monument and accessories shown above were field located on 06-01-04

[Signature]
JAMES R. COLEMAN
Registered Land Surveyor
Florida Certificate No. 3205
Date Signed 07-29-04

BEAN, WHITAKER, LUTZ & KAREH, INC. (LB 4919)
13041 McGregor Boulevard
Fort Myers, Florida 33919-5910
Phone: (239) 481-1331

CO-ORDINATE NO. 8320

BLM REFERENCE NO. T47SR25E440100