

**FLORIDA DEPARTMENT OF ENVIRONMENTAL PROTECTION  
CERTIFIED CORNER RECORD**

**081649**

DOC.# \_\_\_\_\_

**C-01**

**CORNER DESCRIPTION:**

DEPICT CORNER WITH 

**MONUMENTATION DESCRIPTION (EVIDENCE FOUND OR METHOD TO SET):**

FOUND 4" X 4" CONCRETE MONUMENT, 1.0' ABOVE GROUND, WITH BRASS DISK STAMPED

1/4  
1 1/6

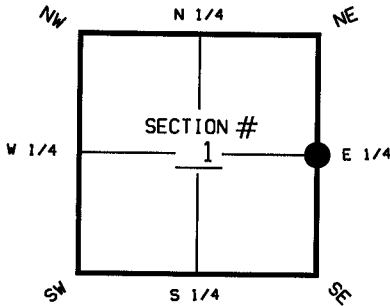

E 1/4 CORNER OF SECTION 1  
TWP. 47 S, RGE 25 E  
TALLAHASSEE BASE MERIDIAN,  
LEE COUNTY(S), FLORIDA

**HORIZONTAL POSITION INFORMATION ( IF DETERMINED ):**

LATITUDE 26° 24' 47.2773" N LONGITUDE 81° 45' 21.9054" W  
Y(NORTHING-FT.) 755925.77 X(EASTING-FT.) 735998.51 ZONE FL WEST  
CONVERGENCE 00° 06' 30.6" SCALE FACTOR 0.99994848

COORDINATE DETERMINATION (CIRCLE ONE): FIELD TRAVERSE  GPS   
HORIZONTAL DATUM (CIRCLE ONE): NAD27 NAD83(1986)  NAD83(1990) OTHER (EXPLAIN) \_\_\_\_\_  
ACCURACY (CIRCLE ONE): 1ST  2ND  3RD  OTHER \_\_\_\_\_

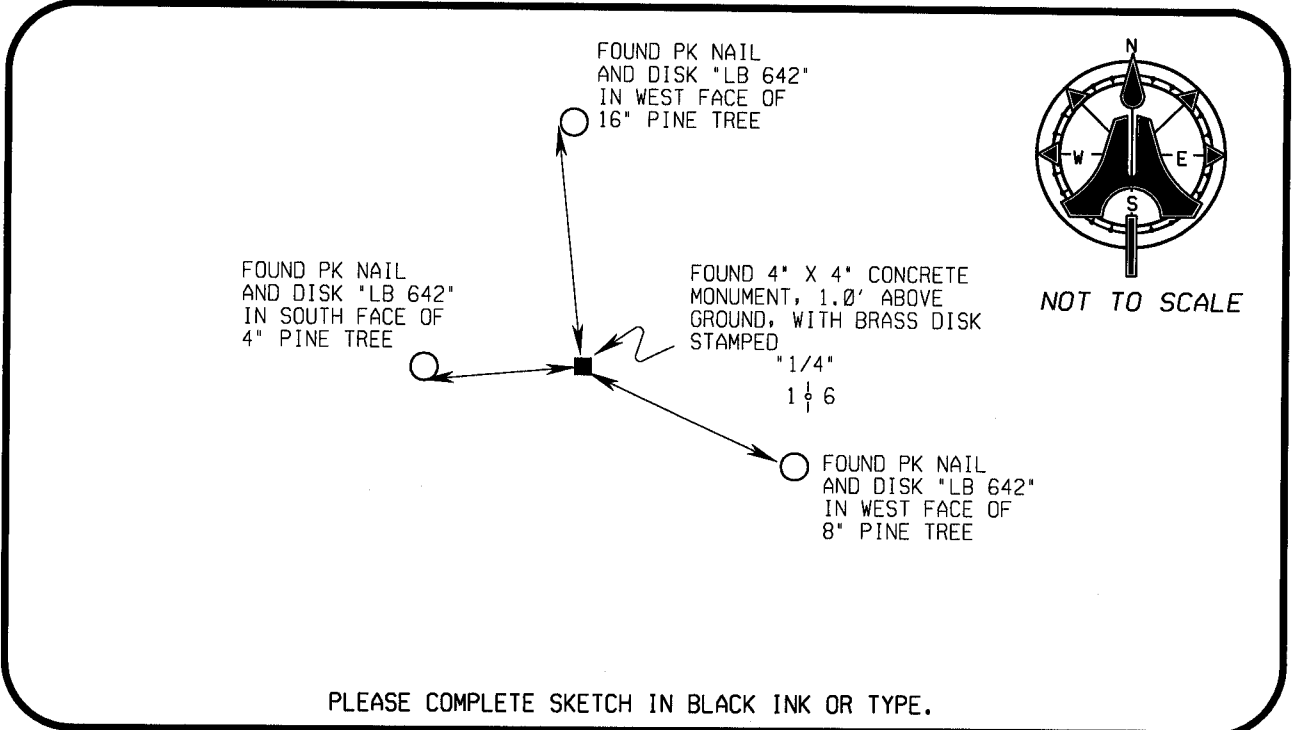

PLEASE COMPLETE SKETCH IN BLACK INK OR TYPE.

**SURVEYORS CERTIFICATE:**

I CERTIFY THE MONUMENT AND ACCESSORIES INDICATED ABOVE WERE FIELD LOCATED ON FEBRUARY 3, 2004

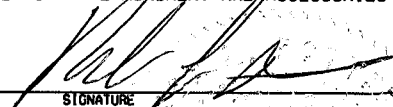
 5688  
SIGNATURE PSM NO.  
AIM ENGINEERING & SURVEYING, INC. LB 3114  
FIRM OR AGENCY LB NO.  
5300 LEE BOULEVARD ADDRESS  
LEHIGH ACRES, FLORIDA 33971-1026 CITY STATE ZIP  
(239) 332-4569 PHONE NUMBER DATE 05/06/04

SEND ORIGINAL TO:  
DEPARTMENT OF ENVIRONMENTAL PROTECTION  
BUREAU OF SURVEYING AND MAPPING  
3900 COMMONWEALTH BOULEVARD  
MAIL STATION 105  
TALLAHASSEE, FLORIDA 32399

D.E.P. USE ONLY  
PROCESSED: 5-12-04  
B.L.M. - I.D. 700 690  
QUAD - I.D. 2019 2140

EMBOSSSED SEAL OVER SIGNATURE