

FLORIDA DEPARTMENT OF ENVIRONMENTAL PROTECTION CERTIFIED CORNER RECORD

DOC. # _____

E-11

CORNER DESCRIPTION: _____ MONUMENTATION DESCRIPTION (EVIDENCE FOUND OR METHOD TO SET) _____

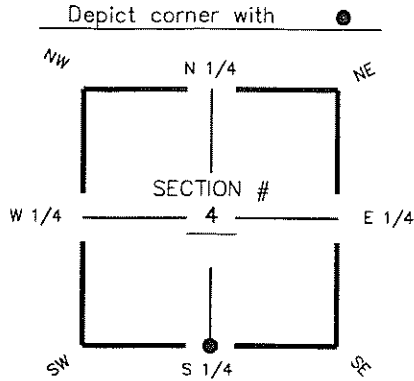

FOUND 3.5" x 3.5"
CONCRETE MONUMENT
WITH 1" IRON PIPE
1.6' BELOW GROUND LEVEL

HORIZONTAL POSITION INFORMATION (if determined):

Latitude 26° 18' 58.5734" N Longitude 81° 48' 39.2699" W
 Y(NORTHING-Ft.) 720688.61 X(EASTING-Ft.) 718106.69 Zone FL W
 Convergence 00° 05' 01.8" Scale factor 0.99994558
 Coordinate determination (circle one): Field traverse (GPS)
 Horizontal datum (circle one): NAD27 NAD83(1986) (NAD83(1999)) other (explain) _____
 Accuracy (circle one): 1st (2nd) 3rd other _____

S 1/4 corner of Section 4
 Twp 48 S, Rge 25 E
 Tallahassee Base Meridian,
LEE County(s), Florida

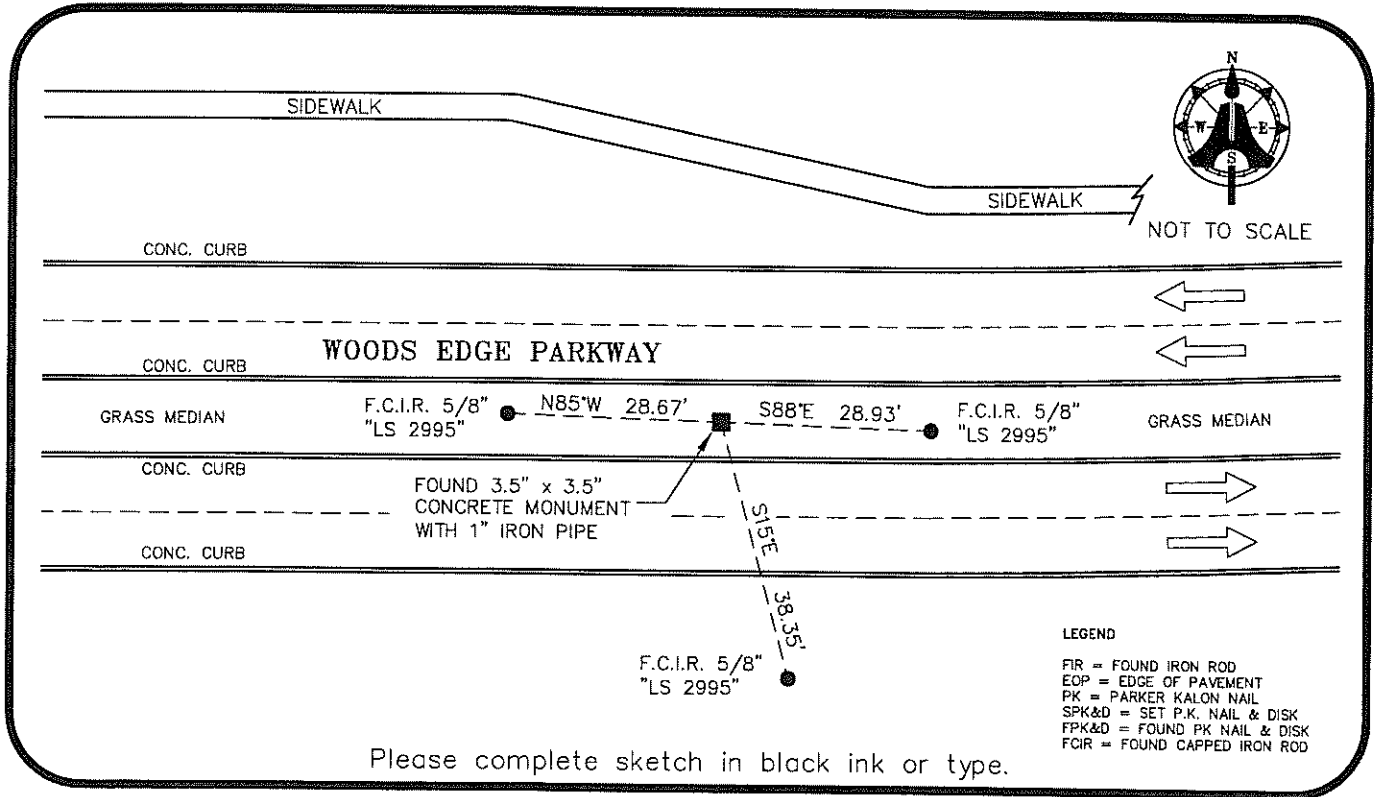

LEGEND
 FIR = FOUND IRON ROD
 EOP = EDGE OF PAVEMENT
 PK = PARKER KALON NAIL
 SPK&D = SET P.K. NAIL & DISK
 FPK&D = FOUND PK NAIL & DISK
 FCIR = FOUND CAPPED IRON ROD

SURVEYORS CERTIFICATE:

I certify the monument and accessories indicated above were field located on APRIL 30, 2008

[Signature] 5688
 SIGNATURE PSM NO.
AIM ENGINEERING & SURVEYING, INC. LB 3114
 FIRM OR AGENCY LB NO.
5300 LEE BOULEVARD
 ADDRESS
LEHIGH ACRES, FLORIDA 33971-1026
 CITY STATE ZIP
(239) 332-4569 03-20-09
 PHONE NUMBER DATE

SEND ORIGINAL TO:
 Department of Environmental Protection
 Bureau of Surveying and Mapping
 3900 Commonwealth Boulevard
 Mail Station 105
 Tallahassee, Florida 32399

D.E.P. USE ONLY
Processed: _____
B.L.M. - I.D. _____
QUAD - I.D. _____

EMBOSSSED SEAL OVER SIGNATURE